



## 920039PL USER MANUAL

Thermal actuators are mainly used in floor heating systems to control closing and opening of the valves. It is specifically applied to electric drive part of the branch manifold valve, small valve and dynamic balance valve. No noise, fast installation and easy disassembly.

### Feature:

Compact size, small dimensions	Fast installation and disassembly
Noiseless	Various adapters
low power consumption	Full view stroke indication

### Technical parameters:

Voltage: 230V/24V/12V version	Adapter: M30x1.5mm/M28x1.5mm
Control direction: Normally closed/Normally open	Cable length: 800MM
Protection Grade: IP54	Standard: EN 60730
Working temperature: -5°C -60°C	Force: 100±10N
Stroke: ≥4mm	Closing and opening time: 3-5mins
Housing material: PA66+30%GF	Power consumption: 2W

### Dimensions:

Unit: MM

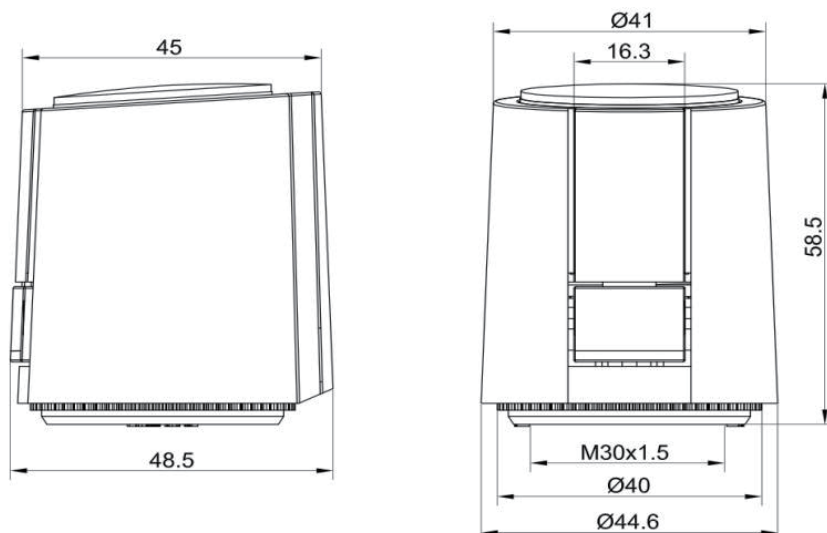

## Installation and disassembly:

### Installation:

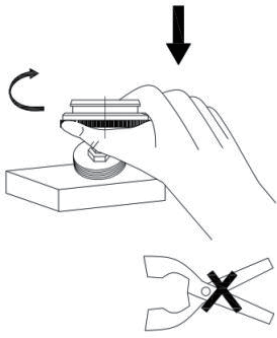

Step 1  
Rotate the nut clockwise  
and install it on the valve

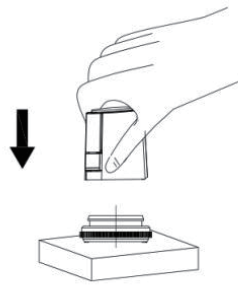

Step 2  
Press down on the actuator  
against the adapter



Step 3  
Finish installation

### Disassembly:



Step 1  
Press the button with your hand

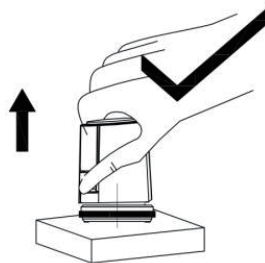

Step 2  
Press and hold the button and  
lift up to remove the actuator

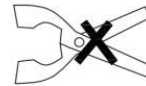

Step 3  
Do not use pipe pliers,  
clamp and other tools

## Installation and debugging precautions:

### Indicating cover status confirmation

### Working situation

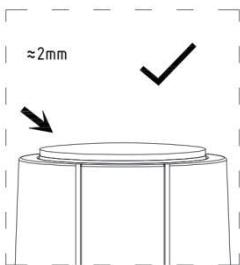

Normal situation

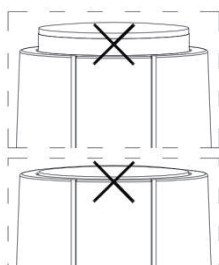

Abnormal situation

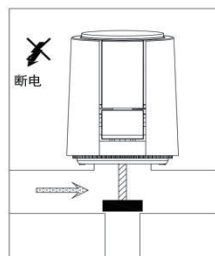

N/C normally closed

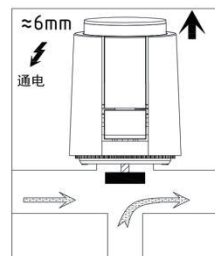

N/C normally open

